

# GETTING CONNECTED

Please follow the steps below to install your LaCie d2 Blu-ray XL.

## STEP 1 - CONNECT THE POWER CABLE

1. Connect the appropriate wall plug adapter for your country to the power supply.



2. Connect the power supply to a wall outlet and to the drive.

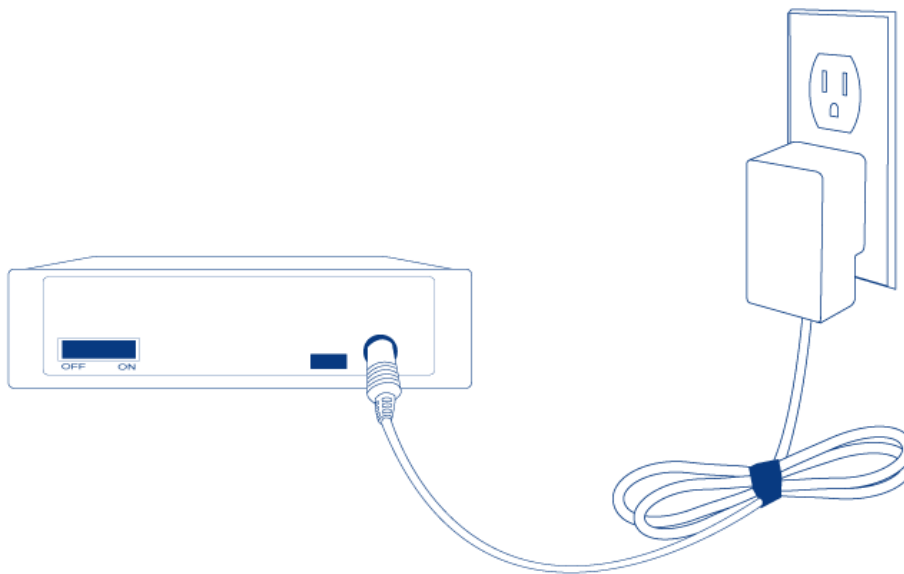

## STEP 2 - CONNECT THE INTERFACE CABLE

Connect the USB 2.0 or FireWire 400 cable from the drive to the computer.

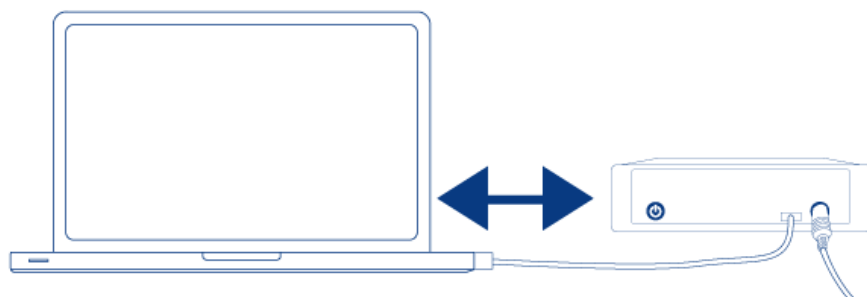

**Important info regarding the interfaces:** Only one interface type may be used to connect your computer to the device. Unmount the drive from your computer if wish to switch between the USB 2.0 and FireWire 400 interfaces.

### Technical note:

#### FireWire Connection:

Daisy chaining multiple non-powered FireWire devices may effect individual performance. To guarantee optimal performance, LaCie recommends daisy chaining *powered* FireWire devices to your LaCie hard drive.

FireWire 800 is backwards-compatible with FireWire 400, which means that you can connect your LaCie FireWire 400 product to a FireWire 800 port on your computer. In this case, file transfers will be limited to FireWire 400 speeds.

## STEP 3 - TURN ON THE DRIVE

Turn the drive's power switch to the **On** position.

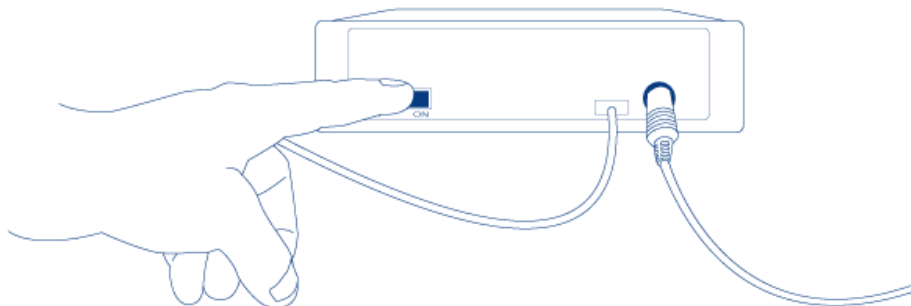

The d2 Blu-ray XL is ready for use. To confirm that it is properly connected to your computer, go to the Apple pulldown menu to select **About This Mac > More Info**. This will open the Apple System Profiler. Your drive should be listed under *Hardware*.

## STEP 4 - DVD SOFTWARE UTILITIES

Insert the included d2 Blu-ray XL DVD into your optical drive to install the software utilities. For more information about a program, please refer to the software's **Help** section.

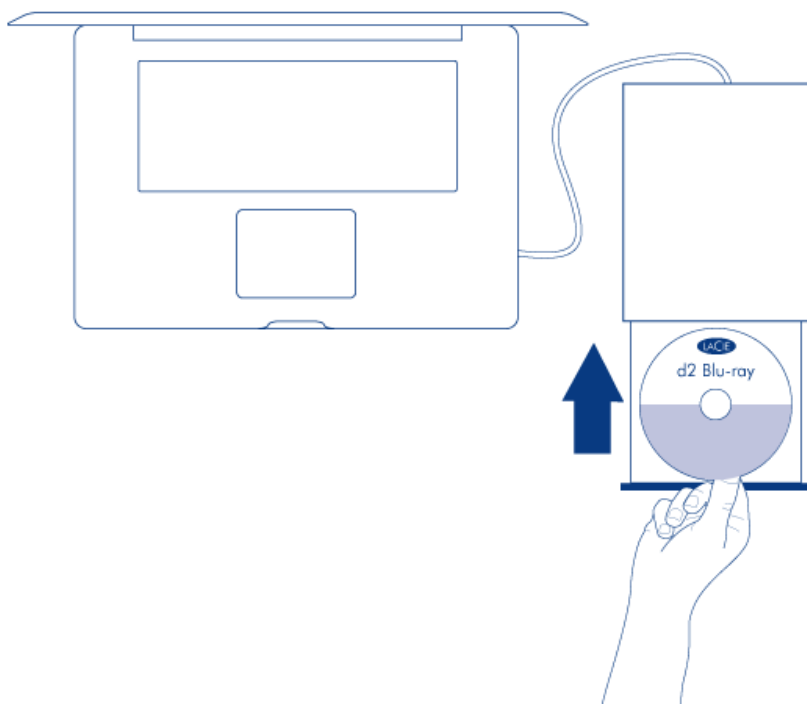

You may be prompted for the software key or serial number the first time you use the application. The number is located on the back of the DVD-ROM sleeve.

**Important info:** Available software will vary according to the drive. Please check the packaging of your product or the label of the included DVD-ROM. For software updates, go to [Software Update](#).